



## Rope Access Pty Ltd T/AS Safety Roof Anchors

P: \*61 2 9939 3523 F: \*61 2 9939 7868  
PO Box 758, Freshwater NSW 2096

ABN: 67 147 756 670 ACN: 147 756 670

sales@safetyroofanchors.com.au  
www.safetyroofanchors.com.au

S.R.A. fully engineered product range

400 Series

Truss-T-Grip®

Profile Grips

Ladder Restraint Brackets

Fixings

### BULB-TITE® RIVETS

The original tri folding aluminium high strength rivet with washer



High performance structural rivets that differs from other rivets due to their blind side propeller shape configuration when installed and their fitted neoprene washer, combining to provide a high strength vibration resistant weather proof joint.

Bulb-tite® have great clamping power and are ideal for thin, low strength, or brittle material such as sheet metal, plastics, fiberglass, composites and curved or uneven material applications

Diameter Size: 5.2, 6.3, 7.7 mm

Material: Aluminium, Steel and Monel/ Stainless steel

Head Styles: Dome Head, Large Flange, Countersunk\*

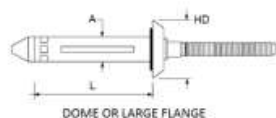

DOMES OR LARGE FLANGE

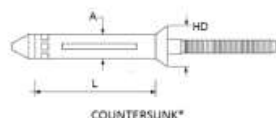

COUNTERSUNK\*

#### Bulb-tite® Key Features

- Ideal for light weight or thin material
- Water tight with neoprene washer
- Propeller shape blind side foot print
- One rivet size through thick & thin
- Ideal for curved or uneven surfaces.

#### Bulb-tite® Applications

- Truck body & roof fabrication
- Height and safety roofing anchors
- Steel construction, cladding & more.

All Aluminium							
Rivet Body: Alu ALMg 5, Mandrel: Alu AlCuMg 1							
Rivet Diameter A (mm)	Huck Aerobolt Universal Code	Grip Min-Max (mm) Material Thickness	Hole Size ±0.1(mm)	Head Dia HD (mm)	Length L (mm)	Shear Typical (Kn)	Tensile Typical (Kn)
Dome Head							
5.2	RV6604-6-03W	1.3 – 4.8	5.4	11.3	17.5	2.7	1.9
	RV6604-6-04W	1.6 – 6.4			19.1		
	RV6604-6-06W	4.7 – 9.5			22.2		
	RV6604-6-08W	7.9 – 12.7			25.4		
	RV6604-6-10W	11.1 – 15.9			28.6		
	RV6604-6-12W	14.3 – 19.1			31.8		
	RV6604-6-14W	17.4 – 22.2			34.9		
	RV6604-6-16W	20.6 – 25.4			38.1		
6.3	RV6604-6-18W	23.8 – 28.6	6.5	14.2	41.3	4.2	2.5
	RV6604-8-04W	1.6 – 6.4			20.2		
	RV6604-8-06W	3.2 – 9.5			23.4		
	RV6604-8-08W	6.4 – 12.7			26.5		
7.7	RV6604-8-10W	9.5 – 15.9	7.9	18.9	29.7	6.6	4.8
	RV6605-9-06W	1.1 – 9.5			28.2		
Large Flange Head							
7.7	RV6605-9-10W	6.4 – 15.9	7.9	18.9	34.5	6.6	4.8

All Steel							
Rivet Body and Mandrel Steel, zinc plated							
Rivet Diameter A (mm)	Huck Aerobolt Universal Code	Grip Min-Max (mm) Material Thickness	Hole Size ±0.1(mm)	Head Dia HD (mm)	Length L (mm)	Shear Typical (Kn)	Tensile Typical (Kn)
Dome Head							
6.3	RV6676-8-06W	3.2 – 9.5	6.5	14.5	23.4	5.5	4.2
7.7	RV6676-9-06W	1.1 – 9.5	8.0	18.9	28.2	N/A	N/A
	RV6676-9-10W	6.4 – 15.9			34.5		
	RV6676-9-12W	9.5 – 19.1			37.7		

Monel/Stainless Steel							
Rivet Body: Monel, Mandrel: Stainless Steel							
Rivet Diameter A (mm)	Huck Aerobolt Universal Code	Grip Min-Max (mm) Material Thickness	Hole Size ±0.1(mm)	Head Dia HD (mm)	Length L (mm)	Shear Typical (Kn)	Tensile Typical (Kn)
Dome Head							
6.3	RV6696-8-04W	1.0 – 6.4	6.5	13.8	23.4	8.2	6.4

\* Due to the variables, the data is a guide & specific testing is recommended. Contact us for further information.